

Pullman Bangkok King Power
Bangkok, Thailand



About

Pullman Bangkok King Power is a resort experience hotel in central Bangkok. Situated in the heart of Bangkok, the hotel offers easy access to the BTS sky train and Suvarnabhumi Airport Rail Link (SARL) which makes the hotel accessible in just 30 minutes from the airport via Phayathai station. Transfer to and from Suvarnabhumi airport is approximately 30 minutes and the Suvarnabhumi Airport Rail Link – Phayathai Station is within walking distance

Indulge in 6 fashionable bars and restaurants, the infinity pool overlooking a botanical garden and exquisite spa. 366 rooms offer the signature Pullman bed and free WiFi throughout the hotel. Meeting facilities cater up to 600 persons.

Unique Meeting Features

- 14 meeting rooms, including Infinity Ballroom and daylight meeting rooms on the 6th floor
- Infinity Ballroom can be divided into 2 rooms with LCD screen 4.5 m x 4.8 m and ansi 6,500 lumens (Infinity 1) and LCD screen 7.2 m x 4.5 m and ansi 10,000 lumens (Infinity 2)
- 520 sq.m pillar less Infinity Ballroom with 7-metre high ceiling
- 178 sq.m foyer’s Infinity Ballroom of length 29.6 m. and width 6 m.
- Tailored Coffee Break
- ‘Chill Out Space’ a stylish private and socialize area on the 6th floor
- Secretarial services
- High-speed Internet and FREE Wi-Fi

Meeting Floor Plans

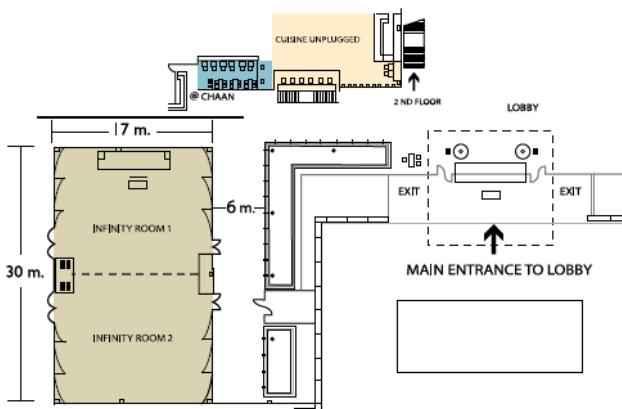

Infinity Ballroom on the ground floor

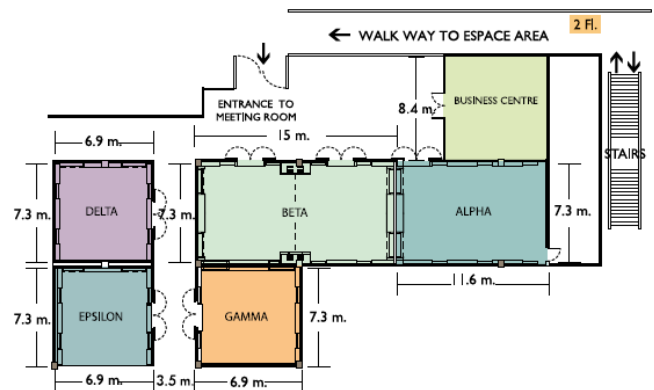

Meeting rooms on the second floor

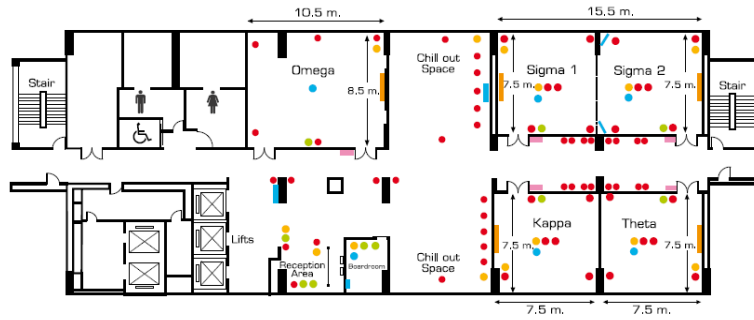

Meeting rooms on the sixth floor

Capacity

Function room	Area (sqm)	U-Shape	Theatre	Classroom	Banquet	Cocktail	Boardroom
6th Floor							
Chill Out	56	-	-	-	-	40	-
Omega	89	30	80	39	-	-	24
Sigma	112	38	120	66	-	-	36
Sigma 1 or 2	56	20	60	27	-	-	18
Kappa	56	20	60	27	-	-	18
Theta	56	20	60	27	-	-	18
4th Floor							
Swimming Pool	-	-	-	-	-	60	-
2nd Floor							
Alpha	85	30	75	50	50	60	24
Beta	110	40	100	60	60	90	36
Beta 1 or 2	50	20	50	30	30	-	18
Gamma	50	20	50	30	30	-	18
Delta	50	20	50	30	30	-	18
Epsilon	50	20	50	30	30	-	18
Déjà Vu	-	-	-	-	100	120	-
Ground Floor							
Infinity	520	90	550	350	400	600	-
Infinity 1 or 2	240	40	200	120	120	200	36
Glen Bar	-	-	-	-	-	100	-
Botanical Garden	-	-	-	-	50	60	-

Facilities

- Outdoor swimming pool with a spacious sun deck
- Fitness Centre – fully equipped with the finest and latest fitness equipment
- Le Spa with 9 treatment rooms set in a tranquil environment
- Botanical Garden – a relaxing atmosphere in a beautifully designed garden with water features
- A complimentary shuttle tuk-tuk to BTS Skytrain at Victory Monument station
- A complimentary shuttle van from hotel to major shopping centers at Ratchaprasong intersection and Rama 1 road.

For more destinations... log on now @ www.asiatravel.com/en-us/mice/

615, Toa Payoh Lorong 4 #01-01

Singapore 319516

Tel: (65) 6352 9148 **Fax:** (65) 6732 1722

Email: raymond@asiatravel.com | andrew@asiatravel.com

Operating Hours:

Monday - Friday: 0900 to 1800hrs

Saturday: 0900 to 1300hrs

*Closed on Sunday & Public Holidays